

3.4 BLOCK FLANGE ACCORDING DIN11864-2 FORM A

TECHNICAL DATA

Standard sizes	<ul style="list-style-type: none"> • DIN DN10 - DIN DN150 • ISO DN08 - ISO DN150 • OD 1/2" - 6"
Material	<p>Medium contacted:</p> <ul style="list-style-type: none"> • Ws. 1.4404 (316L) • Ws. 14435 BN2 (316L) • Special materials e.g. 1.4539, Hastelloy 2.4602, Titan etc. on request <p>Non medium contacted:</p> <ul style="list-style-type: none"> • 1.4301/1.4305 or equivalent
Surface quality	<p>Medium contacted:</p> <ul style="list-style-type: none"> • machined surface Ra < 0,6µm • elektro polished Ra < 0,5µm • elektro polished Ra < 0,25µm • other qualities on request
Tracability	Medium contacted material marked with material number and heat number
Media	Gases and liquids
Operating temperature	-10°C to +150°C
Operating pressure	Kundenseitig bei der Behälterberechnung zu prüfen
Applicable standards	<p>Pipe dimensions:</p> <ul style="list-style-type: none"> • DIN (DIN11866 Reihe A) • ISO (DIN11866 Reihe B) • OD (DIN11866 Reihe C)
Labelling	Ferrule etc.: company name, item number, size,, material, heat number
Certification	<p>Medium contacted:</p> <ul style="list-style-type: none"> • EN 10204 / 3.1

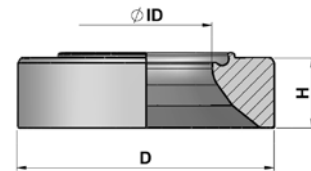

Aseptik-Nutblockflansch n. DIN11864-2

3.4 BLOCK FLANGE ACCORDING DIN11864-2 FORM A

3.4.1 BLOCK FLANGE FEMALE ACCORDING DIN11864-2

Size	Item number	Diam. ID [mm]	Diam. D [mm]	Hight H [mm]								
DIN DN10	1521 1010 0000 0301	10.00	54.00	25 / 38 / 51								
DIN DN15	1521 1015 0000 0301	16.00	59.00	25 / 38 / 51								
DIN DN20	1521 1020 0000 0301	20.00	64.00	25 / 38 / 51								
DIN DN25	1521 1025 0000 0301	26.00	70.00	25 / 38 / 51								
DIN DN32	1521 1032 0000 0301	32.00	76.00	25 / 38 / 51								
DIN DN40	1521 1040 0000 0301	38.00	82.00	25 / 38 / 51								
DIN DN50	1521 1050 0000 0301	50.00	94.00	25 / 38 / 51								
DIN DN65	1521 1065 0000 0301	66.00	113.00	25 / 38 / 51								
DIN DN80	1521 1080 0000 0301	81.00	133.00	25 / 38 / 51								
DIN DN100	1521 1100 0000 0301	100.00	159.00	25 / 38 / 51								
DIN DN125	1521 1125 0000 0301	125.00	183.00	25 / 38 / 51								
DIN DN150	1521 1150 0000 0301	154.00	213.00	25 / 38 / 51								
ISO DN08	1521 2008 0000 0301	10.20	54.00	25 / 38 / 51								
ISO DN10	1521 2010 0000 0301	14.00	59.00	25 / 38 / 51								
ISO DN15	1521 2015 0000 0301	18.10	62.00	25 / 38 / 51								
ISO DN20	1521 2020 0000 0301	23.70	69.00	25 / 38 / 51								
ISO DN25	1521 2025 0000 0301	29.70	74.00	25 / 38 / 51								
ISO DN32	1521 2032 0000 0301	38.40	82.00	25 / 38 / 51								
ISO DN40	1521 2040 0000 0301	44.30	88.00	25 / 38 / 51								
ISO DN50	1521 2050 0000 0301	56.30	103.00	25 / 38 / 51								
ISO DN65	1521 2065 0000 0301	71.50	125.00	25 / 38 / 51								
ISO DN80	1521 2080 0000 0301	84.30	137.00	25 / 38 / 51								
ISO DN100	1521 2100 0000 0301	109.70	168.00	25 / 38 / 51								
OD 1/2"	1521 3005 0000 0301	9.40	54.00	25 / 38 / 51								
OD 3/4"	1521 3007 0000 0301	15.70	59.00	25 / 38 / 51								
OD 1"	1521 3010 0000 0301	22.10	66.00	25 / 38 / 51								
OD 1 1/2"	1521 3015 0000 0301	34.80	79.00	25 / 38 / 51								
OD 2"	1521 3020 0000 0301	47.50	92.00	25 / 38 / 51								
OD 2 1/2"	1521 3025 0000 0301	60.20	107.00	25 / 38 / 51								
OD 3"	1521 3030 0000 0301	72.90	125.00	25 / 38 / 51								
OD 4"	1521 3040 0000 0301	97.40	157.00	25 / 38 / 51								

Available heights:

(Item-no. = 3. Block figure 1-4)

Item-No..	Height
0000	25mm
3800	38mm
5100	51mm

Available materials:

(Item-no. = 4. Block figure 1-3)

Item-No.	Material
030	1.4435 BN2
045	1.4539
060	2.4602 Hastelloy
070	Titan Grade 2

Available surface qualities:

(Item-No. = 4. Block figure 4)

Item-No.	Medium contacted surface
0	machined surface Ra<=0,6µm
1	electro polished Ra<=0,5µm
2	electro polished Ra<=0,25µm

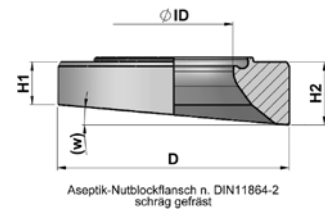

3.4 BLOCK FLANGE ACCORDING DIN11864-2 FORM A

3.4.2 BLOCK FLANGE FEMALE ANGULAR ACCORDING DIN11864-2

Size	Item number	Diam. ID [mm]	Diam. D [mm]	Hight H1 [mm]	Hight H2 [mm]	Angle W [°]						
DIN DN10	1522 1010 0000 0301	10.00	54.00	*	25 / 38 / 51	*						
DIN DN15	1522 1015 0000 0301	16.00	59.00	*	25 / 38 / 51	*						
DIN DN20	1522 1020 0000 0301	20.00	64.00	*	25 / 38 / 51	*						
DIN DN25	1522 1025 0000 0301	26.00	70.00	*	25 / 38 / 51	*						
DIN DN32	1522 1032 0000 0301	32.00	76.00	*	25 / 38 / 51	*						
DIN DN40	1522 1040 0000 0301	38.00	82.00	*	25 / 38 / 51	*						
DIN DN50	1522 1050 0000 0301	50.00	94.00	*	25 / 38 / 51	*						
DIN DN65	1522 1065 0000 0301	66.00	113.00	*	25 / 38 / 51	*						
DIN DN80	1522 1080 0000 0301	81.00	133.00	*	25 / 38 / 51	*						
DIN DN100	1522 1100 0000 0301	100.00	159.00	*	25 / 38 / 51	*						
DIN DN125	1522 1125 0000 0301	125.00	183.00	*	25 / 38 / 51	*						
DIN DN150	1522 1150 0000 0301	154.00	213.00	*	25 / 38 / 51	*						
ISO DN08	1522 2008 0000 0301	10.20	54.00	*	25 / 38 / 51	*						
ISO DN10	1522 2010 0000 0301	14.00	59.00	*	25 / 38 / 51	*						
ISO DN15	1522 2015 0000 0301	18.10	62.00	*	25 / 38 / 51	*						
ISO DN20	1522 2020 0000 0301	23.70	69.00	*	25 / 38 / 51	*						
ISO DN25	1522 2025 0000 0301	29.70	74.00	*	25 / 38 / 51	*						
ISO DN32	1522 2032 0000 0301	38.40	82.00	*	25 / 38 / 51	*						
ISO DN40	1522 2040 0000 0301	44.30	88.00	*	25 / 38 / 51	*						
ISO DN50	1522 2050 0000 0301	56.30	103.00	*	25 / 38 / 51	*						
ISO DN65	1522 2065 0000 0301	71.50	125.00	*	25 / 38 / 51	*						
ISO DN80	1522 2080 0000 0301	84.30	137.00	*	25 / 38 / 51	*						
ISO DN100	1522 2100 0000 0301	109.70	168.00	*	25 / 38 / 51	*						
OD 1/2"	1522 3005 0000 0301	9.40	54.00	*	25 / 38 / 51	*						
OD 3/4"	1522 3007 0000 0301	15.70	59.00	*	25 / 38 / 51	*						
OD 1"	1522 3010 0000 0301	22.10	66.00	*	25 / 38 / 51	*						
OD 1 1/2"	1522 3015 0000 0301	34.80	79.00	*	25 / 38 / 51	*						
OD 2"	1522 3020 0000 0301	47.50	92.00	*	25 / 38 / 51	*						
OD 2 1/2"	1522 3025 0000 0301	60.20	107.00	*	25 / 38 / 51	*						
OD 3"	1522 3030 0000 0301	72.90	125.00	*	25 / 38 / 51	*						
OD 4"	1522 3040 0000 0301	97.40	157.00	*	25 / 38 / 51	*						

*=gewünschtes Maß bitte angeben

Available heights:

(Item-no. = 3. Block figure 1-4)

Artikel-Nr.	Höhe
0000	25mm
3800	38mm
5100	51mm

Available materials:

(Item-no. = 4. Block figure 1-3)

Item-No.	Material
030	1.4435 BN2
045	1.4539
060	2.4602 Hastelloy
070	Titan Grade 2

Available surface qualities:

(Item-No. = 4. Block figure 4)

Item-No.	Medium contacted surface
0	machined surface Ra<=0,6µm
1	electro polished Ra<=0,5µm
2	electro polished Ra<=0,25µm

Note: Actual data to collect at www.elpotech.de. Specifications and design are subject to change without notice. Date of revision: 05/2018

elpotech GmbH & Co. KG | Max-Eyth-Straße 1 | D-71691 Freiberg a.N. | Tel. +49 (0) 7141-68 87 49 0 | Fax +49 (0) 7141-68 87 49 44 | info@elpotech.de | www.elpotech.de

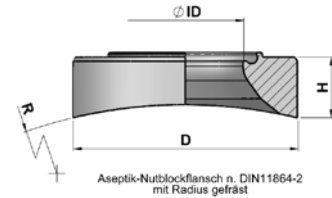

3.4 BLOCK FLANGE ACCORDING DIN11864-2 FORM A

3.4.3 BLOCK FLANGE FEMALE WITH RADIUS ACCORDING DIN11864-2

Size	Item number	Pipe ID [mm]	Diam. D [mm]	Radius R [mm]	Hight H [mm]						
DIN DN10	1523 1010 0000 0301	10.00	54.00	*	25 / 38 / 51						
DIN DN15	1523 1015 0000 0301	16.00	59.00	*	25 / 38 / 51						
DIN DN20	1523 1020 0000 0301	20.00	64.00	*	25 / 38 / 51						
DIN DN25	1523 1025 0000 0301	26.00	70.00	*	25 / 38 / 51						
DIN DN32	1523 1032 0000 0301	32.00	76.00	*	25 / 38 / 51						
DIN DN40	1523 1040 0000 0301	38.00	82.00	*	25 / 38 / 51						
DIN DN50	1523 1050 0000 0301	50.00	94.00	*	25 / 38 / 51						
DIN DN65	1523 1065 0000 0301	66.00	113.00	*	25 / 38 / 51						
DIN DN80	1523 1080 0000 0301	81.00	133.00	*	25 / 38 / 51						
DIN DN100	1523 1100 0000 0301	100.00	159.00	*	25 / 38 / 51						
DIN DN125	1523 1125 0000 0301	125.00	183.00	*	25 / 38 / 51						
DIN DN150	1523 1150 0000 0301	154.00	213.00	*	25 / 38 / 51						
ISO DN08	1523 2008 0000 0301	10.20	54.00	*	25 / 38 / 51						
ISO DN10	1523 2010 0000 0301	14.00	59.00	*	25 / 38 / 51						
ISO DN15	1523 2015 0000 0301	18.10	62.00	*	25 / 38 / 51						
ISO DN20	1523 2020 0000 0301	23.70	69.00	*	25 / 38 / 51						
ISO DN25	1523 2025 0000 0301	29.70	74.00	*	25 / 38 / 51						
ISO DN32	1523 2032 0000 0301	38.40	82.00	*	25 / 38 / 51						
ISO DN40	1523 2040 0000 0301	44.30	88.00	*	25 / 38 / 51						
ISO DN50	1523 2050 0000 0301	56.30	103.00	*	25 / 38 / 51						
ISO DN65	1523 2065 0000 0301	71.50	125.00	*	25 / 38 / 51						
ISO DN80	1523 2080 0000 0301	84.30	137.00	*	25 / 38 / 51						
ISO DN100	1523 2100 0000 0301	109.70	168.00	*	25 / 38 / 51						
OD 1/2"	1523 3005 0000 0301	9.40	54.00	*	25 / 38 / 51						
OD 3/4"	1523 3007 0000 0301	15.70	59.00	*	25 / 38 / 51						
OD 1"	1523 3010 0000 0301	22.10	66.00	*	25 / 38 / 51						
OD 1 1/2"	1523 3015 0000 0301	34.80	79.00	*	25 / 38 / 51						
OD 2"	1523 3020 0000 0301	47.50	92.00	*	25 / 38 / 51						
OD 2 1/2"	1523 3025 0000 0301	60.20	107.00		25 / 38 / 51						
OD 3"	1523 3030 0000 0301	72.90	125.00	*	25 / 38 / 51						
OD 4"	1523 3040 0000 0301	97.40	157.00	*	25 / 38 / 51						

*=gewünschtes Maß bitte angeben

Available heights:

(Item-no. = 3. Block figure 1-4)

Item-No..	Height
0000	25mm
3800	38mm
5100	51mm

Available materials:

(Item-no. = 4. Block figure 1-3)

Item-No.	Material
030	1.4435 BN2
045	1.4539
060	2.4602 Hastelloy
070	Titan Grade 2

Available surface qualities:

(Item-No. = 4. Block figure 4)

Item-No.	Medium contacted surface
0	machined surface Ra<=0,6µm
1	electro polished Ra<=0,5µm
2	electro polished Ra<=0,25µm

Note: Actual data to collect at www.elpotech.de. Specifications and design are subject to change without notice. Date of revision: 05/2018

elpotech GmbH & Co. KG | Max-Eyth-Straße 1 | D-71691 Freiberg a.N. | Tel. +49 (0) 7141-68 87 49 0 | Fax +49 (0) 7141-68 87 49 44 | info@elpotech.de | www.elpotech.de